

ClearSec FOS 90

Manual Full-Height-Turnstile for Internal and External Installation

ClearSec FOS 90 is a robust and elegant full-height-turnstile including a protective roof with water draining system and way mode indicator lights. Delivered as mono-bock and self supporting, it is easily installed and ideal for applications requiring high performance combined with a full stainless steel construction and transparent design.

It is available in single and double-interlocking layout configurations, for installations where space is an issue.

Passage in both directions electronically controlled.

ClearSec FOS 90 offers a standard electromechanical head able to prevent two passages at one time, equipped with damper for a silent mechanism and smooth operation.

In the event of an emergency or power-off scenario, the unit can be configured fail-safe i.e. rotor freely rotates or fail-lock i.e. rotor locks. This option is available either in one or both directions of passage.

From



Bishopsgate

GUNNEBO
For a safer world

ClearSec FOS 90

Technical Specifications

Drive

Hand operated. Logic Voltage 24Vac

Materials

Casework:	304 Grade stainless steel with infill glass panels (5+5security glass)
Rotor Wings:	304 Grade stainless steel
Rotor Spindle:	304 Grade stainless steel
Floor Covering:	Black rubber floor mat

Mechanism

Electro-mechanical head mechanism:

- Positive action lock to prevent two passages at one time
- Self centering mechanism to ensure complete rotation in the rest position
- Anti backup device to prevent reverse rotation once the head moved 30° from rest position
- Hydraulic damper to ensure a smooth and quiet operation

Power Failure / Fire Alarm

In the event of a power failure the rotor wings will remain locked in the fail-lock configuration or can freely rotate in the fail-safe configuration. Fail-Lock or Fail-Safe configuration is available in one or both directions and must be specified at time of order placement. Note that head mechanism fail state will be the same as power failure choice. Input facility available for voltage free contact to effect fire alarm fail state (COMR1 option required)

Interface

LCM02 microprocessor control logic:

- One input for opening/locking the mechanism in each direction
- Two protected outputs for control of the opening/locking solenoids
- Four protected outputs for piloting way mode indicators
- Two 0V output relays indicating availability of use in either direction
- Two 0V outputs to count passage in either direction
- Adjustable time out via parameter change: i.e. Go signal is cancelled if the passage is not completed within a pre-set time (standard default 8sec)

Power Supply / Power Rating

230Vac 50Hz or 115Vac 60Hz

Power Rating 50VA, 50 + 50 VA for Double unit

Without lights option

Operating Temperature / IP Rating / MCBF / MTTR

-5 to +50°C (RH 95% not condensing) / IP34 / 1.5M cycles / less than 30min

Flow Rates (approximate figures)

- Insertion Type Reader, 12 passages per minute
- Swipe Type Reader, 15 passages per minute
- Proximity Reader "Hands Free", 17 passages per minute

Models or Versions

- FOS 90 Single
- FOS 90 Double Interlocking

Options

- Card reader integration
- Switching interface COMR1
- Serial interface RS485
- Remote console
- Internal lighting
- Extra Canopy
- Battery back-up

Applications

- Government
- Retail
- Finance
- Telecommunications
- Information Technology
- Banking
- Publishing
- Leisure
- Petrochemical
- Education

ClearSec FOS 90

Site Preparation: Single Unit

Product delivered fully assembled and requires lifting equipment. Approx. weight 480Kg
(For installation details, please refer to installation layout drawings)

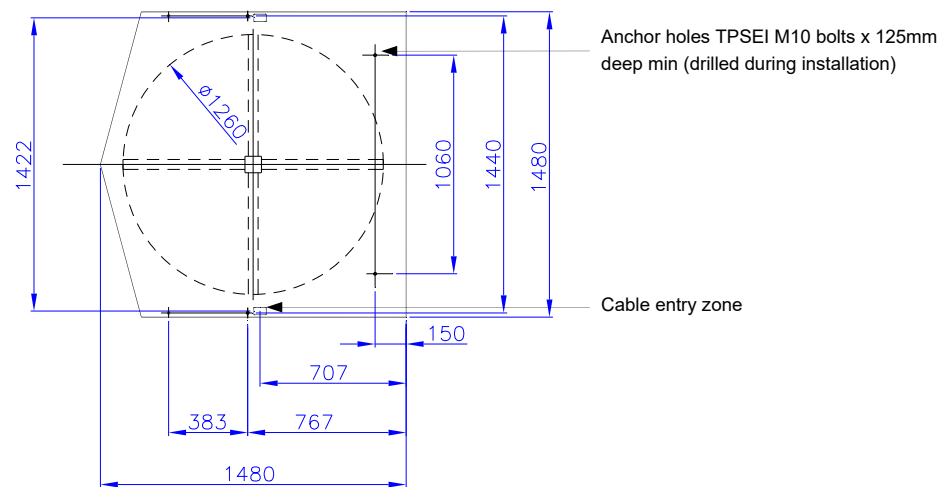
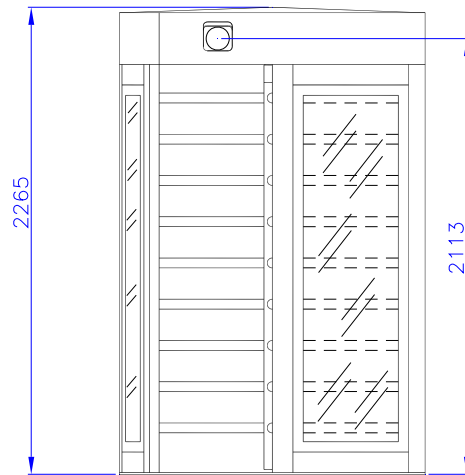

Concrete Base to specification at least fck (cube) 30N/mm² of resistance

Base to be flat and level to +/- 5mm over footprint area. Dimensions to be > 1800 x 1800 x 150 deep min (units in mm)

From



Bishopsgate

GUNNEBO®
For a safer world

ClearSec FOS 90

Site Preparation: Double Interlocking Unit

Product delivered fully assembled and requires lifting equipment. Approx. weight 750Kg
(For installation details, please refer to installation layout drawings)

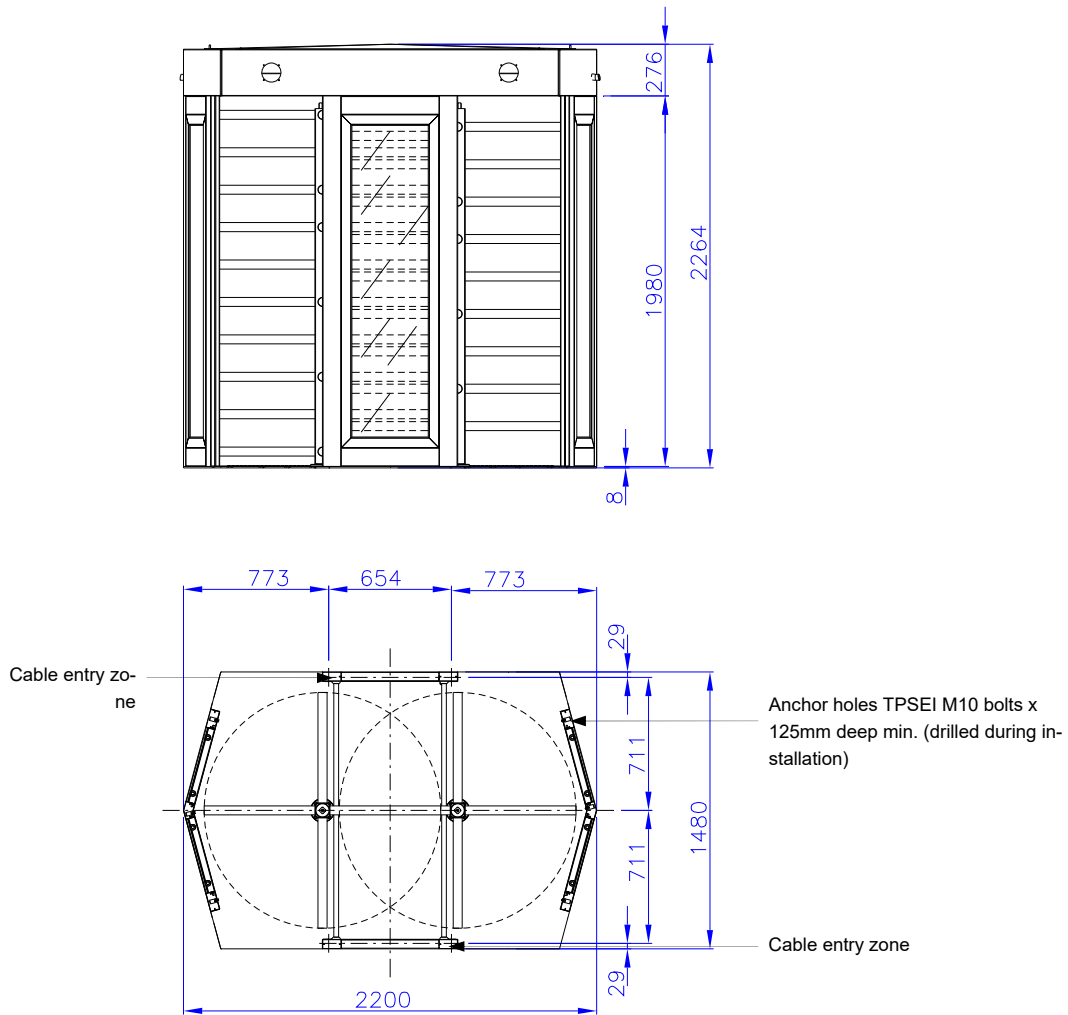

Concrete Base to specification at least fck (cube) 30N/mm² of resistance

Base to be flat and level to +/- 5mm over footprint area. Dimensions to be > 1800 x 2400 x 150 deep min (units in mm)

ClearSec FOS 90

Important

- Any horizontal pipe or conduit running below the ClearSec FOS 90 must be at least 140mm below FFL
- Metal conduit for cables should be raised at least 50mm from foundation
- It is the customer's responsibility to ensure the structural integrity and strength of the installation location
- The dimensions given and pictures shown in this Product Data Sheet are for information only. In order to prepare the installation site, please refer to your usual Gunnebo Customer Service contact

For further information, please contact:



Bishopsgate Int (Nig) Ltd
52a Campbell Street
Lagos Island CBD
Lagos State 100221

Tel. +234 (700) 247-4677-4283
Email: sales@bishopsgate-nq.com
Web: www.bishopsgate-nq.com

Note: In pursuit of its policy of continuous refinement and improvement, Gunnebo Entrance Control reserves the right to modify design and details at any time and without notice.

