



DarTek A

Aluminium Bullet Resistant Doors

From



Bishopsgate

Chubb safes

Trusted the world over.



Gunnebo bullet resistant doors have been designed to protect premises and their occupants against ballistic attacks, whilst maintaining an elegant appearance

The DarTek A range consists of fully certified doors tested by independent bodies according to the relevant European standards (EN 1522) ensuring that Gunnebo meets the toughest security needs and expectations by providing a solution that offers the right protection against the identified risk. Since aluminium is a material easy to shape and form, the DarTek A is an optimal solution to combine design and function requirements.

The ease of integration into the building, the high degree of design choice including dimensions, finishes and colours mean that the DartTek A

doors are versatile and can be used for building refurbishments and new constructions. Additionally the DarTek A range offers a selection of partitions and windows to allow the design of complete façade or enclosure solutions.

Key features

1. Elegant appearance.
2. Certified bullet resistance.
3. Finishes and dimensions versatility.
4. Complementary bullet resistant windows and partitions.

From



Bishopsgate

Material

Framework	Extruded aluminium profile in combination with steel armour
Infill	Laminated security glass or solid infill made of an aluminium panel on the attack side and white colour laminated on the secure side
Finish	Powder coat to RAL 9010, 9006, 7035 or 7037

Standard Equipment

Locking	1-point mechanical Euro Lock
Handle	Lever handle on both secure and attack sides

Construction

Opening	Up to 150° inward and outward (depending upon model)
DIN	Left or right
Clear opening	900mm at 90° opening (2 x 900mm only available with MagTek A0 double leaf)

Reference Standard

The certified bullet resistant range is tested to EN 1522 for the complete doorset. Standard EN 1522 defines 7 bullet resistance levels for:

- Pistols: FB2 to FB4
- Rifles: FB1 and FB7
- Assault rifles: FB5 and FB6
- Shotguns: FSG

Models

- Certified Bullet Resistant Doors DarTek A3 to A6

Options

Alternative RAL colours or anodised finish
Door position contact switch
High security cylinder
Choice of mechanical Euro Lock and electric locks
Push buttons
Choice of handle types
Panic bar

Range Composition

DarTek A

A3-G | A4-G | A5-G | A6-G

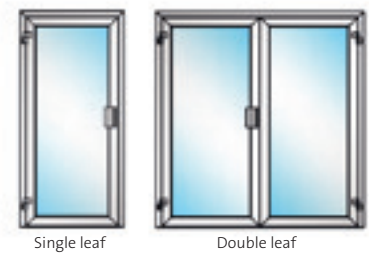

Single leaf

Double leaf

A3-H | A4-H | A5-H | A6-H

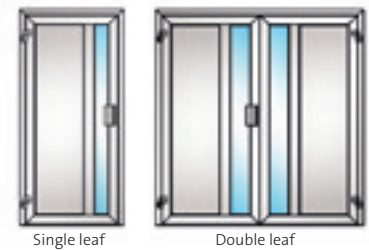

Single leaf

Double leaf

A3-S | A4-S | A5-S | A6-S

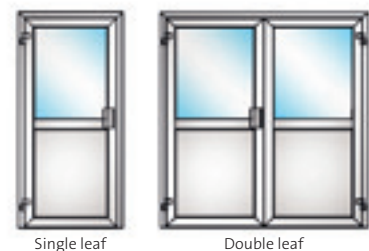

Single leaf

Double leaf

A3-S | A4-S | A5-S | A6-S

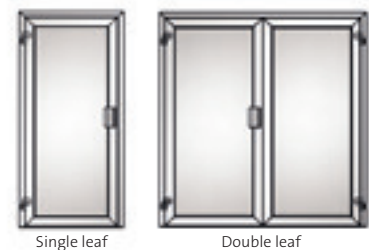

Single leaf

Double leaf

From



Bishopsgate

Standard technical specifications

Model	Type	Rating	Leaf options	Total standard width (Single/Double) (mm)	Total standard height (mm)	Aluminium framework	Infill
DarTek A3-S	Certified Bullet Resistant Doors	FB3 to EN 1522	Single/Double	1150/2150	2130	80mm thick	Solid
DarTek A3-G							Glass BR3 to EN 1063
DarTek A4-S		FB4/FSG to EN 1522	Single/Double	1150/2150	2130	80mm thick	Solid
DarTek A4-G							Glass BR5 to EN 1063
DarTek A5-S		FB5/FSG to EN 1522	Single/Double	1150/2150	2130	80mm thick	Solid
DarTek A5-G							Glass BR5 to EN 1063
DarTek A6-S		FB6/FSG to EN 1522	Single/Double	1150/2150	2130	80mm thick	Solid
DarTek A6-G							Glass BR6 to EN 1063

Optional technical specifications

Model	Non standard width (mm) (Single/Double)	Non standard height (mm)	Electric locking
DarTek A3-S	750–1300/1300–2400	2090–2350	○
DarTek A3-G			
DarTek A4-S	750–1300/1300–2400	2090–2350	○
DarTek A4-G			
DarTek A5-S	750–1300/1300–2400	2090–2350	○
DarTek A5-G			
DarTek A6-S	750–1300/1300–2400	2090–2350	○
DarTek A6-G			

Site Preparation

DarTek A single leaf

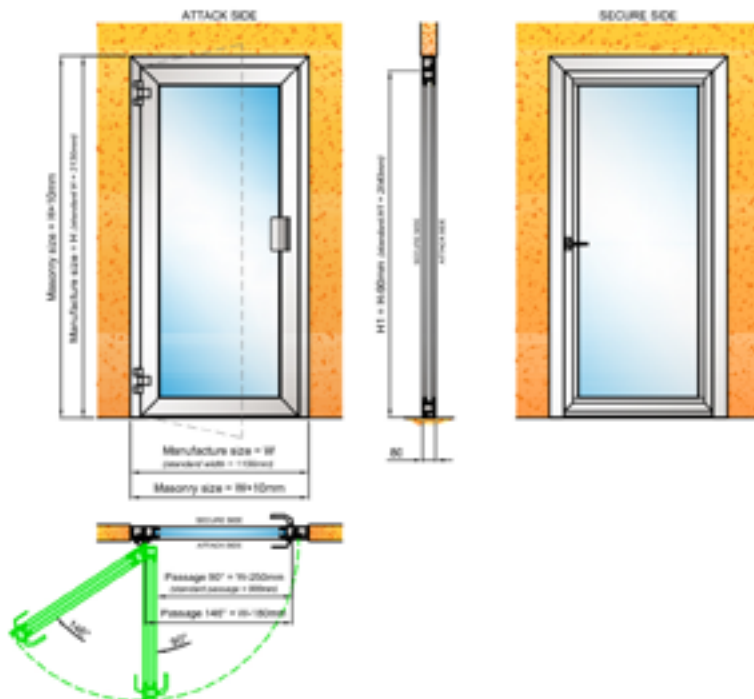

DarTek A double leaf

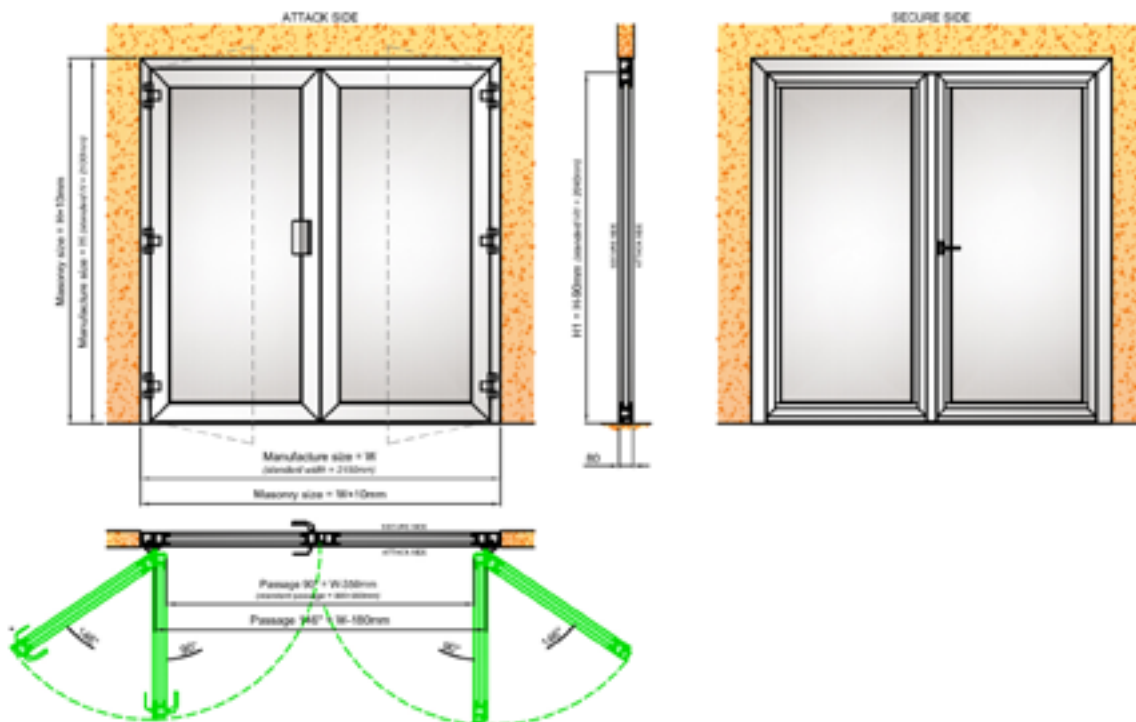

From



Bishopsgate

Notice:

- The product performance depends upon the quality of its installation. All installation details are provided in the DarTek A installation manual.
- A door stop is recommended to prevent any damage to the door closer.
- Any modification of a certified doorset by adding non factory fitted device may result in the loss of certification. Contact Gunnebo for more information.
- Certificates for bullet resistance are available on demand. Contact Gunnebo for any certificates request.
- Any DarTek A door can be upgraded to a DarTek Plus intelligent door. Refer to DorTek Plus product data sheet for more information.

Gunnebo is a leading provider of efficient and innovative security solutions and services to customers around the globe. It employs 5700 people in 32 countries across Europe, Asia, Africa, Australia and the Americas, and has a turnover of €580m. Gunnebo focuses its offering on Bank Security & Cash Handling, Secure Storage, Global Services and Entrance Control.

We make your world safer.



Bishopsgate Int (Nig) Ltd
52a Campbell Street
Lagos Island CBD
Lagos State 100221

Tel. +234 (700) 247-4677-4283
Email: sales@bishopsgate-nq.com
Web: www.bishopsgate-nq.com

Chubbsafes
Trusted the world over.